

The strut bar firmly holds down the body deflection caused by tuning the suspension. It goes without saying that it is highly functional, and it also helps to reduce the strain on the engine compartment. Because it is such an eye-catching part, it was designed with the utmost attention to detail and balance to also look fashionable. Strut bars are a must-have for tuning cars as they are lightweight, functional, fashionable, and have all the necessary elements.

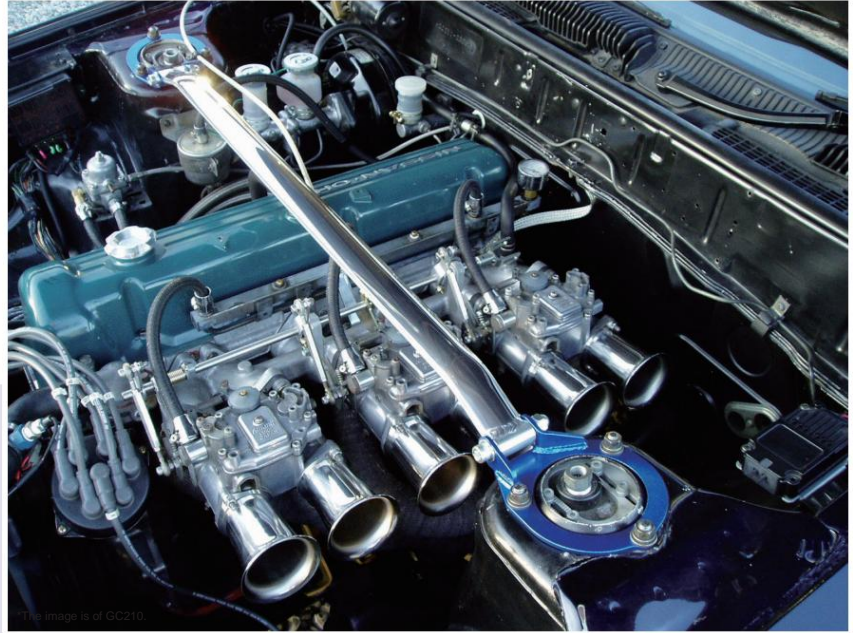

•Aluminum carbon •Aluminum oval •STD type

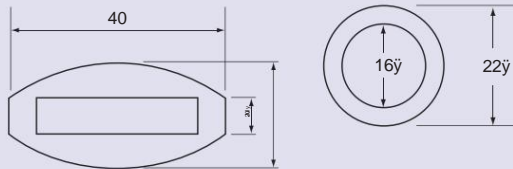

Aluminum carbon strut bar



A high-quality strut bar that pursues excellent functionality and fashionability. Double-layered finish with carbon baked onto an oval cross-section aluminum shaft. The mounting plate has a titanium color finish that brings out a bold image.
(Shaft diameter: width 40, thickness 20)

Compatible models: Front: S30, S130, GC10, GC110, GC210, TE27 Rear: S30

Price: Front: ¥22,000 Rear: ¥22,000

•Bracket color
•Titanium color for all vehicles

Aluminum oval strut bar



A high-quality strut bar that pursues excellent functionality and fashionability. A high-grade product made of oval-shaped aluminum material with a buffed surface.

(Shaft diameter: width 40 thickness 20)

Compatible models: Front: S30, S130, GC10, GC110, GC21 Rear: S30

Price: Front: ¥16,000 Rear: ¥16,000

•Bracket color
•Titanium color: S30 •Blue: S130, GC10, GC110, GC210

STD type strut bar



A standard strut bar that is both lightweight and functional. Made from an aluminum pipe with an outer diameter of $\varnothing 22$, the hairline surface finish creates a calm look.

(Shaft diameter: $\varnothing 22$)

Compatible models: Front: S30, GC10, GC110, Rear: S30

Price: Front: ¥13,500 Rear: ¥13,500

•Bracket color: All blue

Upper mount spacer



This part is attached to the top of the upper mount to raise the vehicle height. It can be used to prevent interference with the muffler when the vehicle height is too low, or to ensure the minimum ground clearance for vehicle inspections.

Compatible models: Front S30 Rear S30, S130, R30, GC210

Thickness: 25mm / 35mm

Price: 1set unit ¥15,000

Steering damper canceller

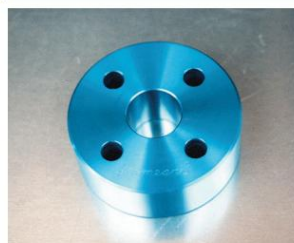

By replacing the stock rubber damper with a machined aluminum part, the damper effect is cancelled, resulting in quicker handling characteristics.

Material: Duralumin (A2017S) *Blue anodized

Compatible models: S30, S130

Price: 1set unit ¥6,000

* The later model S130 is available with damper thicknesses of 25mm and 9mm. Please check.

Long hub bolt



Racing hub bolts that are 15mm longer than the original! Thread length: 35mm Neck length: 50mm Thread pitch: M12 x P1.25 (for Nissan vehicles) Press-fit dimensions (serration): 13mm

Compatible models: S30, S31, S130, GC10, GC110, GC210, R30, R31, B110, B210, B310, S13, 510, 610, etc.

Price: 8-piece set: ¥5,000 10-piece set: ¥6,500

GC10, GC110 Rear suspension spacer



A part that is attached to the top of the rear suspension to raise the vehicle height by approximately 20 mm.

Material: Duralumin (A2017S)

Price: 1set unit ¥13,000