

SOLEX4 type 44ý exploded view and parts list (S type/4 type)

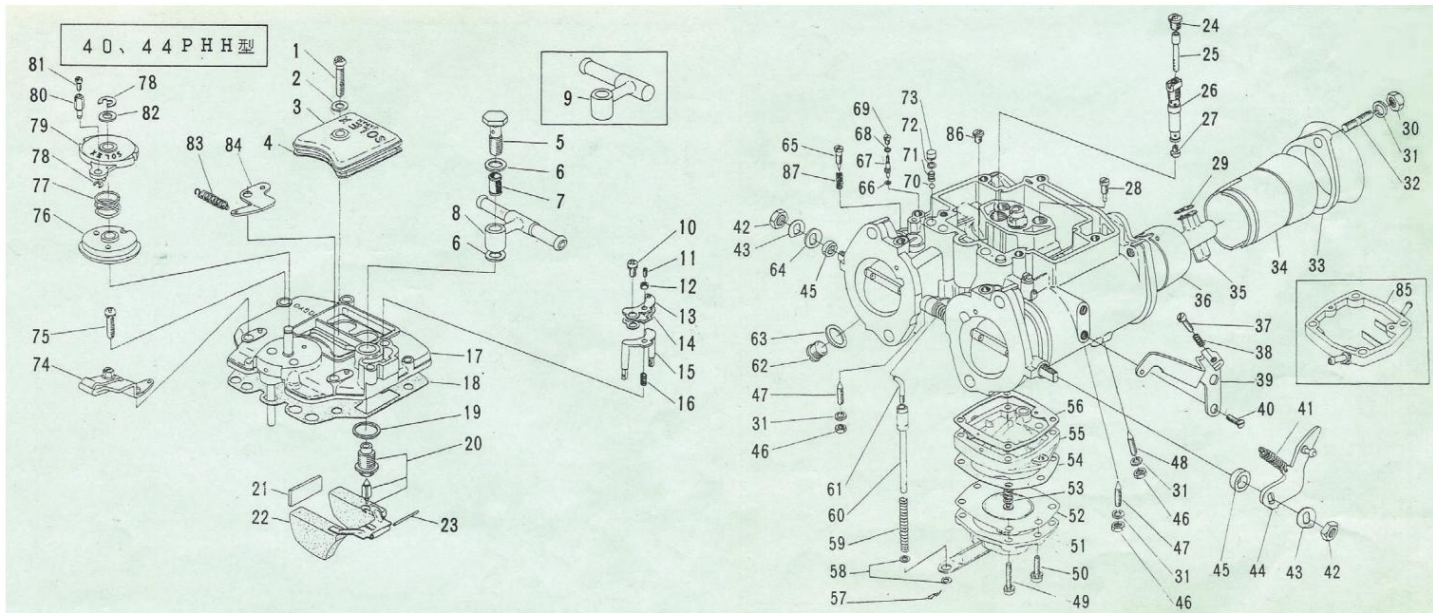

Parts Price List

Number	Part Number	Product Name	necessary amount		Base price
			S type 4 cylinder	4 type 6 cylinder	
1	N115,050	Screw, jet chamber cover ,washer, Type 4		3	140
	N115,106		2		140
---	BV223/40	cover, jet	2	3	70
---	N115,014	chamber (reproduction)		3	3,000
	N115,012	S-type cover, jet chamber gasket,	2		660
---	N107,018	jet chamber		3	300
	N115,103	ý	2		300
5	N101,023	Bolt, banjo Washer	2	3	1,000
6	N101,080	Filter Assy	4	6	140
7	N101,092	(OER reused product) Fuel pipe	2	3	450
8	N115,028	Assy (T) Fuel pipe Assy (L)		2	4,000
9	N115,033	Fuel pipe Assy (straight)		3	3,300
	N101,339	Screw, with washer Screw, float level	1	1	4,000
10	CW2=0512	adjuster Nut Plate (reproduction)	1	3	70
11	N115,005	product) Gasket Float hanger Spring	2	3	240
12	N101,260	Float	2	3	170
13	N115,009	chamber cover Assy	2	3	750
14	N115,010		2	3	200
15	N115,016		2	3	1,200
16	N115,015		2 2 2	3	170
17	N115,403			3 3	-
	N115,100	ý	2		-
18	N115,013	Gasket, float chamber cover		3	550
	N121,019	ý			550
19	N114,011	Gasket, needle valve Needle	---	3	120
20	N115,037	valve assembly (1.8 2.0 2.3) Plate Float	2	3	2,850
21	N115,018	assembly	2	3	240
22	N115,011	Pin, float Jet,	2	3	3,300
23	BD28/44	main air	2	3	170
24	B42/56		4		640
	B42/55	ý		6	640
25	N101,190	Pipe, main bleed Jet block	4		1,000
26	N101,188	assembly (B) Jet block assembly	4		3,300
	N101,253	(OA) Jet, main jet, pilot gasket, small		6	3,300
27	N100,604	venturi Same	4	6	640
28	N101,043		4	6	640
29	N101,019			6	200
	N121,188		4		200
30	N1-06	Nut	8	12	140
31	W4-06	Washer	8	12	70
32	N101,147	Stud bolt	8		440
	T3-0616	ý		12	440
33	O-101193	Air funnel (L-50mm) Air funnel	---		4,500
	O-101,240	(L-50mm) Air funnel (L-75mm)		6	4,500
	K-101,207	Venturi small		6	6,300
35	N121,106		---		-
	N101,205	ý		6	3,500
36	N121,015	Venturi large (31,32,34,36) Same (34,37) Same	---		4,000
	N107,203	(36,38,40) Screw, throttle adjust		6	4,000
	K107,203	Same Spring, throttle adjust		6	3,500
37	N101,176		2		350
	N115,053			3	350
38	4/148		2		170
	N115,057	ý		3	170
39	N107,073	Bracket, throttle stop screw,	2	3	1,650
40	N107,026	bracket spring, throttle	4	6	200
41	N107,112	return nut washer Type 4 lever	2	3	660
42	BDC36/35		4	6	140
43	B42/75	assembly	4	6	140
44	N107,071	S type lever		3	2,000
	N115,104	assembly *The (Reprint)	2		2,500

part numbers shown above are S type for 40ý and type 4 for 44ý.

Number	Part Number	Product Name	necessary amount		Base price
			S type 4 cylinder	4 type 6 cylinder	
45	BDC36/325	Seal, throttle shaft Nut Screw	8	12	200
46	N3-06	Same	8	12	140
47	N107,174	Same Screw	4	6	240
48	N107,784	with		6	240
	N107,173		4		240
49	CW2=0422	washer	8		70
	CW2=0435	ý		12	70
50	CW2=0416	ý	4	6	70
51	N101,067	Cover Assy	2	3	-
52	N107,030	Diaphragm Assy	2	3	2,310
53	N101,056	Spring, pump	2	3	170
54	N107,048	Gasket, pump cover	2	3	200
55	N102,219	Body Assy		3	-
	N121,067	ý Gasket, pump body	2		-
56	N107,012		2	3	200
57	Y-1006	Split pin	2	3	70
58	BV26/32	Thin washer		3	70
	RFT40	Thick washer		3	70
	VM15/252	Washer	4		70
59	N101,030	Springs, pump	2	3	270
60	N102,220	rods, pump (reproduction)	2	3	900
61	N107,831	rods, connecting		3	900
	N121,034	ý	2		900
62	N101,097	Plug screw Same		6	470
	N121,024		---		470
63	BD34/44	Washer		6	100
64	N107,106	Color (reproduction)	2	3	360
65	N101,181	screw, pilot Same		6	500
	N110,266		4		900
66	N102,065	Gaskets, pump nozzles	4	6	70
67	N102,202	Nozzles, pumps		6	1,200
	N121,033	ý	4		1,200
68	BV223/18	O-ring	4	6	100
69	N102,026	Plug screw Ball	4	6	270
70	N110,081	Weight,	4	6	140
71	N115,060	pump Same		6	170
	N121,035		---		170
72	B21/156	O-ring		6	80
73	N102,064	Pump plug		6	200
74	N107,134	Bracket assembly,			1,650
75	CW2=0525	Screw with washer Starter	1	115	70
76	N107,118	disc	10 2		-
	N107,247	ý		3	-
77	N101,063	Spring, starter disc snap ring	2	3	300
78	BSW28/69	cover, starter	2	3	140
79	N101,083	terminal bolt washer	2	3	-
80	N107,019	spring,	2	3	-
81	B2=0508	starter	2	3	170
82	M10/59	return	2	3	70
83	B30/61	bracket, starter jet, starter	2	3	500
84	N115,067		2	3	600
86	B42/55			3	640
	N102,221	ý			-
87	N110,209	Spring, pilot screw	---		170
	4/148	ý		6	170
88	N107,843-1A	Type 3 Repair Kit (1 unit)	2	3	4,230
	N115,086-1A	S type Same	2		4,230
	N115,088-1A	S-5 type, 4 ý (Reprint)	2		5,000
	N115,087-1A	type, 3 type ý	2	3	4,230
89	15D113	Side lever kit		3	5,230
	15D114	S type Same 4 (Reprint)	---		5,730
	15D113	type Same		3	5,230