

# 2TG overhaul parts

## 2TG 1,626cc 86mm diameter forged street piston (regular specification)



- Piston specifications**
- Type: High compression
  - Manufacturing method: Forged and machined
  - Piston diameter: φ86
  - Displacement: 1,626cc
  - Compression ratio: 9.0:1
  - Piston head height: 4.7mm
  - Pin height: 39.0mm
  - Pin diameter x length: φ22x52mm
  - Piston ring thickness: 1.5-1.5-2.8mm
  - Piston weight: 321g
  - Piston pin weight: 85g
  - Valve recess: Compatible with STD valves
  - Connecting rod used: 2TG STD
  - Crank used: 2TG STD

Note:  
This piston is designed specifically for hemispherical combustion chambers.  
Cannot be used with laser heads (multi-spherical combustion chambers).  
Requires bushing insertion and full floating processing of the connecting rod small end.

**Price: ¥105,000**  
(Updated 2026.01.01)

## 2TG 1,626cc 86mm diameter forged street piston (high-octane specification)



- Piston specifications**
- Type: High compression
  - Manufacturing method: Forged and machined
  - Piston diameter: φ86
  - Displacement: 1,626cc
  - Compression ratio: 9.8:1
  - Piston head height: 7.0mm
  - Pin height: 39.0mm
  - Pin diameter x length: φ22 x 52mm
  - Piston ring thickness: 1.5-1.5-2.8mm
  - Piston weight: 328g
  - Piston pin weight: 85g
  - Valve recess: Compatible with STD valves
  - Connecting rod used: 2TG STD
  - Crank used: 2TG STD

Note:  
This piston is designed specifically for hemispherical combustion chambers.  
Cannot be used with laser heads (multi-spherical combustion chambers).  
Requires bushing insertion and full floating processing of the connecting rod small end.

**Price: ¥105,000**  
(Updated 2026.01.01)



**2T-G Standard Valve**

Compatible: 2T-G/2T-GEU  
Size: IN: 44.5φ EX: 38.5φ  
Price: ¥3,000/Single ¥24,000/SET



**2TG STD valve seat ring**

Specification: High strength sintered alloy (lead-free)  
Compatible: For standard valves  
Price: ¥16,000

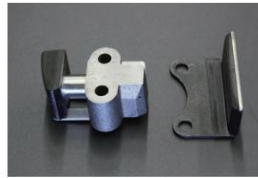

**2T-G Primary side tensioner**

compatible: 2T/2T-G/2T-GEU  
Price: Primary tensioner ¥3,700  
Primary chain guide ¥900



**2TG STD valve guide**

Compatible with: 2TG, 18RG  
Material: Cast iron (same as genuine)  
Price: ¥12,000/SET ¥1,500/Single



**2TG Reinforced Head BoltSet**

Compatible: 2TG, 18RG  
Material: Chrome molybdenum steel  
Price: ¥19,000



**2TG alternator bracket**

Specifications: Plated finish  
Compatible with: Genuine alternator to black alternator  
Price: ¥2,500



**2TG Big Valve Seat Ring**

Specification: High strength sintered alloy (lead-free)  
Compatible: For 45/40.5φ valves  
Price: ¥16,000



**2T-G Disc Cap & Rotor**

Part Number: 33012 (Cap Outer Diameter 77φ)  
Compatible with: 2T-G Mid-Late Model  
Price: ¥3,380/SET



**2TG Disc Cap & Rotor**

Part number: 31013 (cap outer diameter 74φ)  
Compatible with: 2T-G initial model  
Price: ¥4,110/SET



**2TG StainlessSteel 4-2 OctopusFoot**

Price: ¥135,000 (Updated 2026.01.19)  
Part Number: 510-22412 (FUJITSUBO)  
Compatible with: TA22, TA27, TE27  
Pipe outer diameter: 42.7φ



**2TG Oil Pump Assembly**

\*Large Capacity Oil Pump Assembly ¥47,000  
\*STD oil pump assembly ¥21,000

Compatible with: TA22, TA27  
\*When using with the TE27 series, the shape of the strainer part is different, so please replace it.



**2TG manifold stud bolt**

\*2TG Early Model IN (M8 size) ¥220  
EX (M8 size) ¥220  
\*2TG Late Model IN (M8 size) ¥220  
EX (M10 size) ¥230



**2TG ARP reinforced connecting rod bolt**

Made by ARP (USA) ¥14,500  
Torque and elongation can be controlled  
Authentic reinforced bolts!

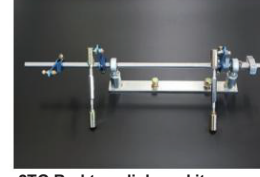

**2TG Rod-type linkage kit**

Can be used with left-hand lever types of SOLEX, WEBER, and OER  
¥25,000

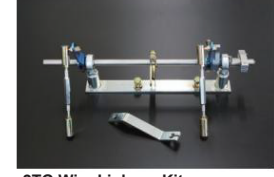

**2TG Wire Linkage Kit**

Can be used with left-hand lever types of SOLEX, WEBER, and OER  
¥25,000

## 2T-G Engine Main Parts Tightening Torque

Fastening point	Toyota Service Data	Reference reinforced
	Tightening Torque (kg-m)	bolt tightening torque (kg-m)
Cylinder head bolts	7.2-8.8	9.0
Main bearing cap bolts	7.2-8.8	
Connecting rod bolts	4.0-5.0	5.0-5.5
Crank pulley bolts	4.0-6.0	
Tappet cover nuts	0.4-0.7	
Cam bracket mounting nuts	1.2-1.8	
Cam sprocket center bolts	7.0-8.0	14.0-16.0
No.2 Chain tensioner x cylinder head	3.0-4.0	
No.1 Chain tensioner x cylinder block	1.0-1.6	
Intake manifold nut	1.0-1.6	
Oil pan mounting bolt	0.5-0.8	
Timing chain cover x cylinder block	1.0-1.6	
Oil pump x cylinder block	1.7-2.6	
Flywheel bolt	7.7-8.3	13.0-13.5
Clutch cover bolt	1.5-2.0	3.5-4.0

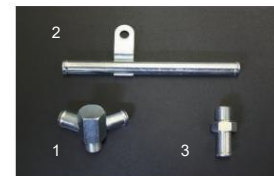

**For TE27 2TG**

1•Heater connector 17-14φ fork ¥4,800  
2•Heater pipe 14φ straight ¥4,600  
3•Heater connector 14φ-3/8 ¥1,500

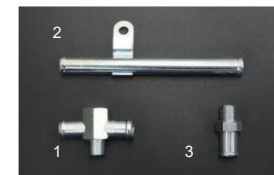

**For TA22/TA17 2TG**

1•Heater connector 17-17φ fork ¥4,800  
2•Heater pipe 17φ straight ¥4,600  
3•Heater connector 17φ-3/8 ¥1,500