

L20 ENGINE TUNING PARTS

L20 modified 2,726cc SPL kit



Unit price: ¥888,000
(Piston, connecting rod, crank, head GK)

γ Forged racing piston Piston diameter 82γ/82.5γ Pin height 29mm Ring thickness 1.2-1.2-2.5mm Recess depth 3.7/3.7mm Individual weight 236g

γ Chromoly I-section narrow width connecting rod Manufacturing method: Forged + machined Center distance: 137.5mm Bolt: ARP Weight: Approximately 470g

82.0γ piston + I-section connecting rod + 85mm full counter = 2,693cc 82.5γ piston + I-section connecting rod + 85mm full counter = 2,726cc γ85mm full counter crankshaft Note) Valve relief processing is required on the exhaust side of the cylinder block. γBead type head gasket (free thickness selection)

L20 modified 2.5 liter A kit



Unit price: ¥563,000
(Piston, connecting rod, crank, head GK)

γ Forged racing piston Piston diameter 82γ/82.5γ Pin height 29mm Ring thickness 1.2-1.2-2.5mm Recess depth 3.7/3.7mm Individual weight 236g

γ Chromoly I-beam connecting rod Manufacturing method: Forged + machined Center distance: 139.5mm Bolt: ARP Weight: Approx. 490g

82.0γ piston + I-section connecting rod + L28 machined crank = 2,502cc 82.5γ piston + I-section connecting rod + L28 machined crank = 2,533cc γ79mm L28 machined crankshaft Note) Valve clearance is required on the exhaust side of the cylinder block. γ Bead type head gasket (free thickness selection)

L20 modified 2.7 liter SPL-A kit



Unit price: ¥847,000
(Piston, connecting rod, crank, head GK)

γ Forged racing piston Piston diameter 82γ/82.5γ Pin height 29mm Ring thickness 1.2-1.2-2.5mm Recess depth 3.7/3.7mm Individual weight 236g

γ Chromoly I-beam connecting rod Manufacturing method: Forged + machined Center distance: 137.5mm Bolt: ARP Weight: Approx. 490g

82.0γ piston + I-section connecting rod + 83mm full counter = 2,629cc 82.5γ piston + I-section connecting rod + 83mm full counter = 2,661cc γ83mm full counter crankshaft Note) Valve relief processing is required on the exhaust side of the cylinder block. γBead type head gasket (free thickness selection)

L20 modified 2.5 liter B kit



Unit price: ¥505,000
(Piston, connecting rod, crank, head GK)

γ Forged racing piston Piston diameter 82γ/82.5γ Pin height 29mm Ring thickness 1.2-1.2-2.5mm Recess depth 3.7/3.7mm Individual weight 236g

γ Chromoly lightweight connecting rod Manufacturing method: Forged Center distance: 139.5mm Bolt: ARP Weight: Approximately 620g

82.0γ piston + lightweight connecting rod + L28 processed crank = 2,502cc 82.5γ piston + lightweight connecting rod + L28 processed crank = 2,533cc Note) Valve relief processing is required on the exhaust side of the cylinder block. γ Bead type head gasket (free thickness selection)

L20 modified 2.7 liter SPL-B kit



Unit price: ¥789,000
(Piston, connecting rod, crank, head GK)

γ Forged racing piston Piston diameter 82γ/82.5γ Pin height 29mm Ring thickness 1.2-1.2-2.5mm Recess depth 3.7/3.7mm Individual weight 236g

γ Chromoly lightweight connecting rod Manufacturing method: Forged Center distance: 137.5mm Bolt: ARP Weight: Approximately 620g

82.0γ piston + lightweight connecting rod + 83mm full counter = 2,629cc 82.5γ piston + lightweight connecting rod + 83mm full counter = 2,661cc γ83mm full counter crankshaft Note) Valve relief processing is required on the exhaust side of the cylinder block. γBead type head gasket (free thickness selection)

L20 modified 2.5 liter-STD kit



Body: ¥371,000 (Piston, Crank, Head GK)

γ Forged street piston Piston diameter 82γ/82.5γ Pin height 35.5mm Ring thickness 1.2-1.2-2.5mm Recess depth 3.7/3.7mm Individual weight 289g

γ 79mm L28 machined crankshaft •Material S40C Hardness HRC20 Manufacturing method: genuine forged Weight: 22kg Stroke: 79mm Rotational balance: within 4gf/cm Bending: within 2/100mm Crank key: 1 key processed

82.0γ piston (PH35.5) + L28 machined crankshaft = 2,502cc 82.5γ piston (PH35.5) + L28 machined crankshaft = 2,533cc Note) Valve relief processing is required on the exhaust side of the cylinder block.

The L20 (early model) genuine connecting rod is fully flow processed and used.

γ Bead type head gasket (free thickness selection)

Reference: Valve relief machining diagram for the exhaust side of the cylinder block

Note) The standard L20 recess only accommodates a valve lift of 10mm. For high lift, not only is the recess depth insufficient, but the valve position also changes with the inclination of the valve, so please machine it in the position shown in the diagram below. The depth varies depending on the cam lift and head conditions. Please note that the limit is 0.5mm before the top ring.

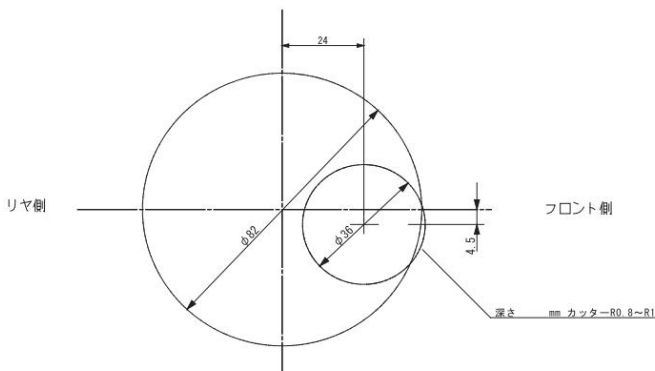

注記

図はシリンダー番号1、4、5のリセス向きを示す
2、3、6、シリンダーはリセスがリヤ側になる

図はL20シリンダーに33φEXバルブを使用した
場合の加工図である

L20 modified L24 modified L28 79mm crankshaft



L20 modified to 2.6γ L24 modified to 2.8γ L28 modified to 3.0γ *Genuine modified crankshaft

Details: Material, S40C
hardness, HRC20
Genuine forged
manufacturing method, 22kg
method, weight, 79mm 4gf/cm
stroke, or less 2/100mm
rotation balance, bending, etc. fully processed

*Unit price: ¥229,000